

IEC Appliance Inlet C14, with Line Switch 2-pole, Voltage Selector and Fuseholder 1or 2-pole



Description

- Panel Mount :
Screw-on version from front or rear side , Appliance Inlet , Protection class I , Voltage Selector , Line Switch 2-pole
- Solder terminals or quick connect terminals

Approvals

- UL File Number: E88880
- CSA File Number: 1084381

Characteristics

- With voltage selector and line switch

References

- Last order date: 30.06.2017
- Last delivery date: 30.09.2017

Weblinks

[pdf datasheet](#), [html-datasheet](#), [General Product Information](#), [RoHS](#), [CHINA-RoHS](#), [REACH](#), [Distributor-Stock-Check](#), [Accessories](#), [Detailed request for product](#)

Newly available variants corresponding to V-Lock mating cordset. The connector is equipped with a notch intended for use with the latching cordset. The cord latching system prevents against accidental removal of the cordset.

Technical Data

Ratings IEC	10A / 250VAC; 50Hz	appliance inlet/-outlet	C14 acc. to IEC 60320-1
Ratings UL/CSA	10A / 250VAC; 60Hz		UL 498, CSA C22.2 no. 42 (for cold conditions) pin-temperature 70 °C, 10A, Protection Class I
Dielectric Strength	> 1.5 kVAC between L-N > 3 kVAC between L/N-PE (1 min/50Hz)	Fuseholder	1 or 2 pole, acc. to IEC 60127-6, for fuse-links 5 x 20mm
Allowable Operation Temperature	-25 °C to 70 °C	Power Acceptance @ Ta > 23°C	Admissible power acceptance at higher ambient temperature see derating curves
IP-Protection	from front side IP 20 acc. to IEC 60529	Line Switch	Rocker switch 2-pole, non-illuminated or illuminated black, acc. to IEC 61058-1 Technical Details
Insulation cover	Suitable for appliances with protection class I acc. to IEC 61140	Voltage Selector	Step switch, 2 positions
Terminal	Solder terminals or quick connect terminals		
Material: Housing	PA6, black, UL 94V-0		

Detailed information on product approvals, code requirements, usage instructions and detailed test conditions can be looked up in [General Product Information](#)

Dimensions

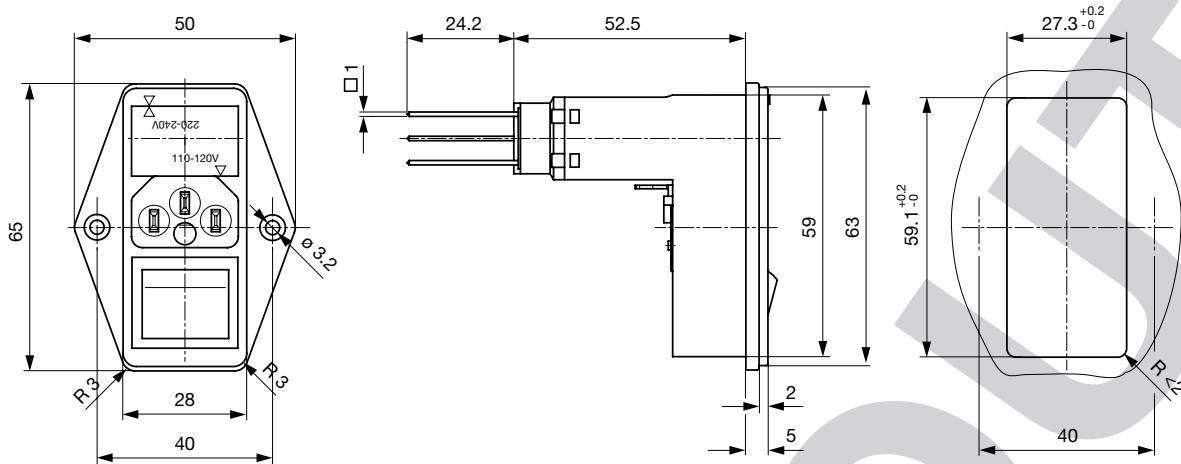

Length of the terminal please find at the order code configuration table

Config. Code

6766 - H - ABCN - D - EGOP

The characters are placeholders for the correspondingly keys of selections from the key tables.

6766 - **H** - ABCN - D - EGOP = Type

Type	Configuration key
protection class I	X

Terminal N	Configuration key
Blade terminal (4.8 x 0.8 mm)	8
Blade terminal (6.3 x 0.8 mm)	9
connection to switch	C
Symbols similar as in table A	

6766 - H - **A** BCN - D - EGOP = Terminals

Terminal L	Configuration key
short solder terminal (L = 4.8 mm)	2
long solder terminal (L = 8.5 mm)	3
Blade terminal (2.8 x 0.8 mm)	7
Blade terminal (4.8 x 0.8 mm)	8
Blade terminal (6.3 x 0.8 mm)	9
connection to switch	C

6766 - H - AB **C** N - D - EGOP = Terminals

Terminal Ground	Configuration key
short solder terminal (L = 4.8 mm)	2
long solder terminal (L = 8.5 mm)	3
Blade terminal (2.8 x 0.8 mm)	7
Blade terminal (4.8 x 0.8 mm)	8
Blade terminal (6.3 x 0.8 mm)	9
Symbols similar as in table A	

6766 - H - ABC **N** - D - EGOP = Terminal Fuseholder

Terminal Fuseholder	Configuration key
PCB-terminal standard (additional solder terminal)	4

6766 - H - A **B** CN - D - EGOP = Terminals

Terminal N	Configuration key
short solder terminal (L = 4.8 mm)	2
long solder terminal (L = 8.5 mm)	3
Blade terminal (2.8 x 0.8 mm)	7

Symbols similar as in table A

6766 - H - ABCN - **D** - EGOP = Color

Color	Configuration key
Black	A

6766 - H - ABCN - D - **E** GOP = Style

Style	Configuration key
flange with countersunk holes	1

Features	Configuration key
voltage selector with 2 fuses	7

6766 - H - A B C N - D - E G O P = Mass S

Mass "s"	Configuration key
00	

The dimension "S" is displayed in (1/10 mm). This information is also valid for the order code

6766 - H - A B C N - D - E G O P = Features

Features	Configuration key
voltage selector with 1 fuse	6

6766 - H - A B C N - D - E G O P = Switches

Switches	Configuration key
not used	0
dead cover	1
bipolar switch, 4,8mm blade terminal, black rocker	4
bipolar switch, solder terminals, black rocker	5
bipolar switch, 4,8mm blade terminal, rocker red illuminated	6
bipolar switch, solder terminal, rocker red illuminated	7
bipolar switch, 4,8mm blade terminals, rocker green illuminated	8
bipolar switch, solder terminals, rocker green illuminated	9

All Variants

Type	Terminal L	Terminal N	Terminal Ground	Features	Switches	Config. Code	V-Lock	Order Number
protection class I	connection to switch	connection to switch	long solder terminal (L = 8.5 mm)	voltage selector with 2 fuses	not used	6766-X-CC34-A-10070		4304.6096
protection class I	connection to switch	connection to switch	long solder terminal (L = 8.5 mm)	voltage selector with 2 fuses	bipolar switch, 4,8mm blade terminal, black rocker	6766-X-CC34-A-10074		4304.6097
protection class I	connection to switch	connection to switch	long solder terminal (L = 8.5 mm)	voltage selector with 2 fuses	bipolar switch, solder terminals, black rocker	6766-X-CC34-A-10075		4304.6098
protection class I	connection to switch	connection to switch	long solder terminal (L = 8.5 mm)	voltage selector with 2 fuses	bipolar switch, solder terminals, rocker green illuminated	6766-X-CC34-A-10079		4304.6099
protection class I	connection to switch	connection to switch	Blade terminal (2.8 x 0.8 mm)	voltage selector with 2 fuses	bipolar switch, 4,8mm blade terminal, black rocker	6766-X-CC74-A-10074		4304.6100
protection class I	connection to switch	connection to switch	Blade terminal (4.8 x 0.8 mm)	voltage selector with 2 fuses	not used	6766-X-CC84-A-10070		4304.6101
protection class I	connection to switch	connection to switch	Blade terminal (4.8 x 0.8 mm)	voltage selector with 2 fuses	bipolar switch, 4,8mm blade terminal, rocker red illuminated	6766-X-CC84-A-10076		4304.6102
protection class I	connection to switch	connection to switch	Blade terminal (6.3 x 0.8 mm)	voltage selector with 2 fuses	not used	6766-X-CC94-A-10070		4304.6103
protection class I	connection to switch	connection to switch	Blade terminal (6.3 x 0.8 mm)	voltage selector with 2 fuses	bipolar switch, 4,8mm blade terminal, black rocker	6766-X-CC94-A-10074		4304.6104

The listed variants should be available from stock Other versions on request www.schurter.com/contact

Most Popular.

Availability for all products can be searched real-time: <http://www.schurter.com/en/Stock-Check/Stock-Check-SCHURTER>

Packaging unit 50 Pcs

Mating Outlets/Connectors

Category / Description



[Appliance Outlet Overview complete](#)

IEC Appliance Outlet F, Screw-on Mounting, Front Side, Solder Terminal	4787
IEC Appliance Outlet F, Snap-in Mounting, Front Side, Solder or Quick-connect Terminal	4788
IEC Appliance Outlet F or H, Screw-on Mounting, Front Side, Solder, PCB or Quick-connect Terminal	5091

[Appliance Outlet further types to 6766](#)

[Connector Overview complete](#)

4782 Mounting: Power Cord, 3 x 1 mm ² / 3 x 18 AWG, Cable, Connector: IEC C13	4782
4022 Mounting: Power Supply Cord, 3 x 1.5 mm ² , Screw clamps, Connector: IEC C13	4022
4785 Mounting: Power Cord, 3 x 1 mm ² / 3 x 18 AWG, Cable, Connector: IEC C13	4785
4300-06 Mounting: Power Cord, 3 x 1 mm ² / 3 x 18 AWG, Cable, Connector: IEC C13	4300-06
4012 Mounting: Power Supply Cord, 3 x 1.5 mm ² , Screw clamps, Connector: IEC C13	4012
Connector further types to 6766	...

Mating Outlets/Connectors shuttered

[Power Cord Overview complete](#)

VAC13KS, Overview, diverse Connector IEC C13, cord end:	VAC13KS
Power Cord further types to 6766	

PHASE!