

# COMPONENTS / ACCESSORIES

## HORIZONTAL RAILS



### Rear horizontal rail, centre (D1)



When using 6 U PCBs or box-type plug-in units. Facility for the attachment of Z rails, insulating strips or conductive strips.

- 84 tapped holes M2.5
- M4 thread on end face
- Straight-through core hole
- Horizontal rail 192 HP for cutting to the required length

**Material:**  
Extruded aluminum section

**Surface finish:**  
Clear-chromated or anodized

Usable width (HP)	Packs of	Order No.
40	1	<b>3684.963</b>
42	1	<b>3684.580</b>
63	1	<b>3684.581</b>
84	1	<b>3684.582</b>
84	1	<b>3685.270<sup>1)</sup></b>
858.5 mm	1	<b>3684.579</b>
192	1	<b>3688.003<sup>2)</sup></b>

<sup>1)</sup> Including 2 assembly screws  
<sup>2)</sup> Anodized

#### ! Also required:

Assembly screws M4 x 12, packs of 100, order no. 3654.300, see page 164

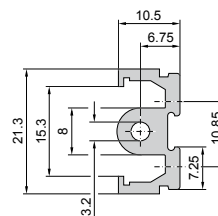
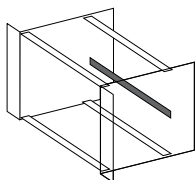

### Rear horizontal rail, centre, with integral Z rail (D2)



When using 6 U PCBs or box-type plug-in units. Integral Z rail for mounting connectors to IEC 60 603-2.

- 84 tapped holes M2.5
- M4 thread on end face
- Straight-through core hole

**Material:**  
Extruded aluminum section

**Surface finish:**  
Clear-chromated

Usable width (HP)	Packs of	Order No.
42	1	<b>3687.600</b>
63	1	<b>3687.601</b>
84	1	<b>3687.602</b>
858.5 mm	1	<b>3687.603</b>

#### ! Also required:

Assembly screws M4 x 12, packs of 100, order no. 3654.300, see page 164

