

REV.	DESCRIPTION	DATE
A	RELEASE	2012.11.12

RoHS

NOTES:

- Insulator Material: PBT, UL 94V-0
- Contact Plating: TIN, 80-100µ"
- Contact Material: Brass
- Current Rating : 1A AC,DC
- Contact Resistance: 20MΩ Max.
- Dielectric Withstanding: AC 500V
- Insulator Resistance: 1000MΩ Min.
- Operating Temp.: -40°C~+105°C

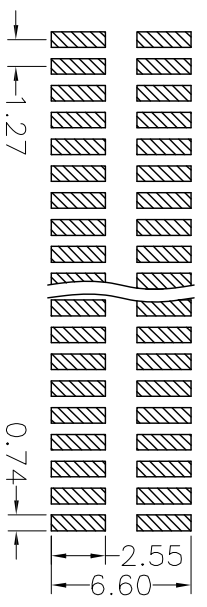
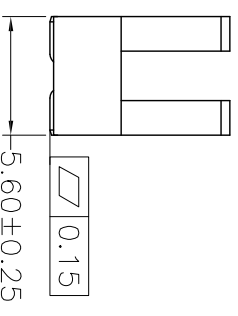
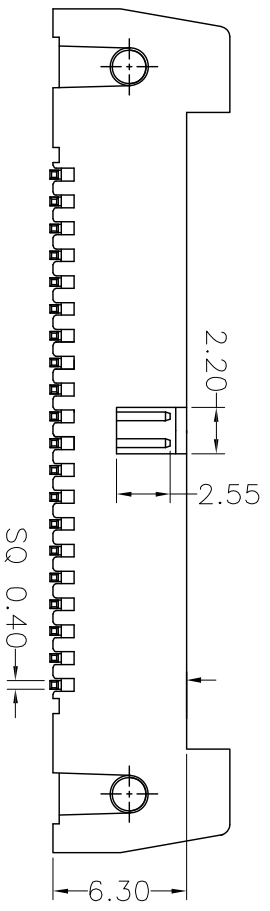
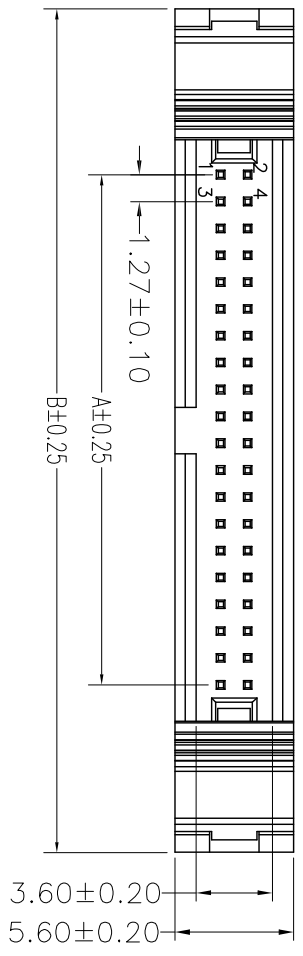

P.C.B LAYOUT

NUMBER OF POSITIONS	DIMENSION	
	A	B
06	2.54	18.31
08	3.81	19.58
10	5.08	20.85
12	6.35	22.12
14	7.62	23.39
16	8.89	24.66
20	11.42	27.20
26	15.24	31.01
30	17.78	33.55
34	20.32	36.09
40	24.13	39.90
50	30.48	46.25
60	36.83	52.60
64	39.37	55.14

Cnc Tech, LLC

3210-XX-003-11-99

UNLESS TOLERANCE		DRAW	BY
GENERAL	ANGLE	DESIGN	BY
X ± 0.30	X° ± 3.0°	CHECK	BY
.X ± 0.20	.XX ± 2.0°	APPROVE	BY
.XX ± 0.15	.XXX ± 1.0°	SCALE	SHEET
.XXX ± 0.08	.XXX ± 0.5°	SCALE	UNIT

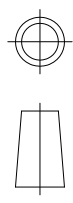

1:1 1/1 MM

DRW NO: REV: A